



Supplement to Yanmar Kit Installation Instructions

SAFETY

This product is designed and intended only for use with a YANMAR engine. All safety and warning information contained in the Yanmar Operation Manual and Service Manual is adopted and incorporated to apply to the components, accessories, and parts that are utilized with Yanmar engines. Follow all instructions and precautions before installing this product, before operating, during operation, and during periodic maintenance procedures for your safety, the safety of others, and to protect the performance of your engine.



Item	Part No.	Description	Quantity	Remarks
1	129F88-44300	Bracket, Left Side	1	
2	129F88-44310	Bracket, Right Side	1	
3	129F88-44330	Plate, Rad Bottom Brkt	1	
4	129F88-44320	Mount, Upper	1	
5	129F88-44340	Support, Upper	1	
6	129689-44870*	Bolt, 1/2 X 2.75 - 13, (Hex)	2	
7	129F88-44350	Bolt, M10 X1.5 - 25, (Flanged, serrated Hex Head)	8	
8	129689-44290*	Bolt, M8 X 1.25 - 16 (Flanged, serrated hex head)	4	
9	129F88-44360	Isolator, 31.75 x 31.75, M8X1.25	2	
10	129689-44890*	Isolator, 46.4mm, 51.21mm, 1/2 X 13	2	
11	129689-44860*	Washer, 0.5 X 2.0 X 0.125	2	
12	129689-44280*	Nut, M8 X 1.25 (Flanged Hex Head)	2	
13	129F88-12010	Bolt, M10 X1.25 - 25, (Flanged Hex Bolt)	2	

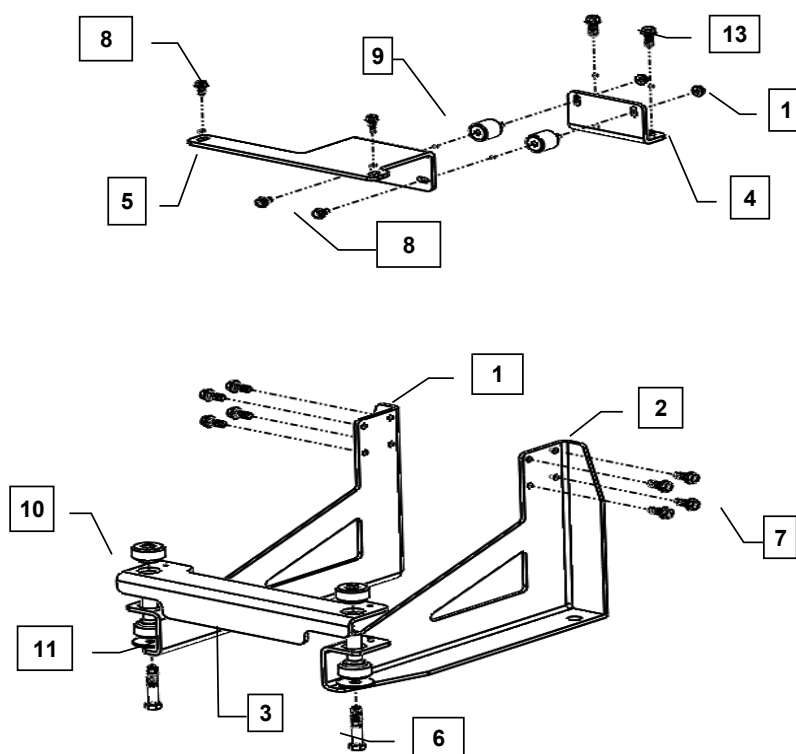

MODELS
4TNV94FHT-NYEA2

Note: Service parts are denoted by an asterisk. To replace non-service parts, the entire kit will need to be purchased.



Installation Instructions

Hand tighten all bolts and nuts until assembly is completed, then torque according to specifications in Table 1. The numbers in () represent the item numbers.

1. Using two M8 X 1.25 -25mm bolts (13), fasten the Upper Mount (4) on top of the front Aftertreatment bracket. Refer below picture for mounting location (highlighted in red).
2. Fasten two M8 Isolator (9) and Support Mount (5) to Upper Mount (4) using M8 X 1.25 - 16mm bolt (8) and M8 X 1.25 nut (12).
3. Assemble Left Front Leg (1) and Right Front Leg (2) to front engine mounting pads using M10 X 1.5 - 25mm bolts (7) provided in the kit.
4. Locate Radiator Bottom Bracket (3) onto Front Legs using guide pins. Assemble Isolators (10) in large openings at the sides of the Cross Bracket.
5. Install the Radiator Kit and refer to Radiator Kit instructions to complete assembly.

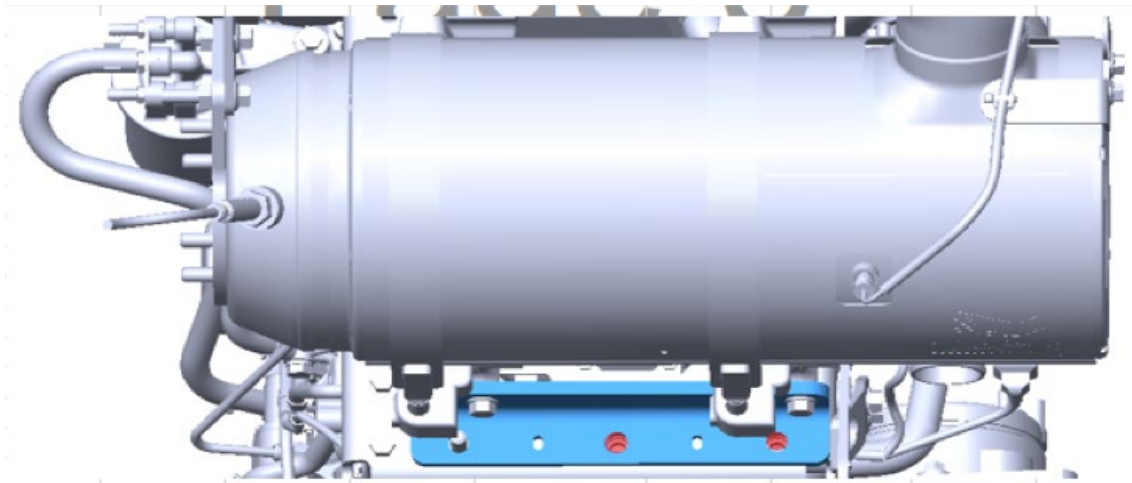

NOTE: Comply with torque standards in the table to avoid unexpected damage during installation or in the future.

TABLE 1: Tightening Torque

Diameter x Pitch	Kgf-m	Foot-lbf	N-m
M8 x 1.25	1.5 ~ 2.9	10.6 ~ 20.9	14.4 ~ 28.3
M10 x 1.50	4.5 ~ 5.5	32.5 ~ 39.8	44.0 ~ 54.0
1/2 X 2.75	7.9 ~ 10.1	57 ~ 73	77.3 ~ 98.9