



Supplement to Yanmar Kit Installation Instructions

## SAFETY

---

This product is designed and intended only for use with a YANMAR engine. All safety and warning information contained in the Yanmar Operation Manual and Service Manual is adopted and incorporated to apply to the components, accessories, and parts that are utilized with Yanmar engines. Follow all instructions and precautions before installing this product, before operating, during operation, and during periodic maintenance procedures for your safety, the safety of others, and to protect the performance of your engine.



Item	Part No.	Description	Quantity	Remarks
1	119128-13500*	Muffler	1	
2	119128-13560*	Tail Pipe	1	
3	129107-13550*	Gasket, Tail Pipe	1	
4	26306-080002*	Nut, M8 X 1.25 (Flanged hex head)	4	
5	26106-080252*	Bolt, M8 X 1.25 - 25 (Flanged hex head)	4	
6	119749-13600*	Outlet Flap	1	
7	119515-13200*	Gasket, Muffler	0	Included w/ engine

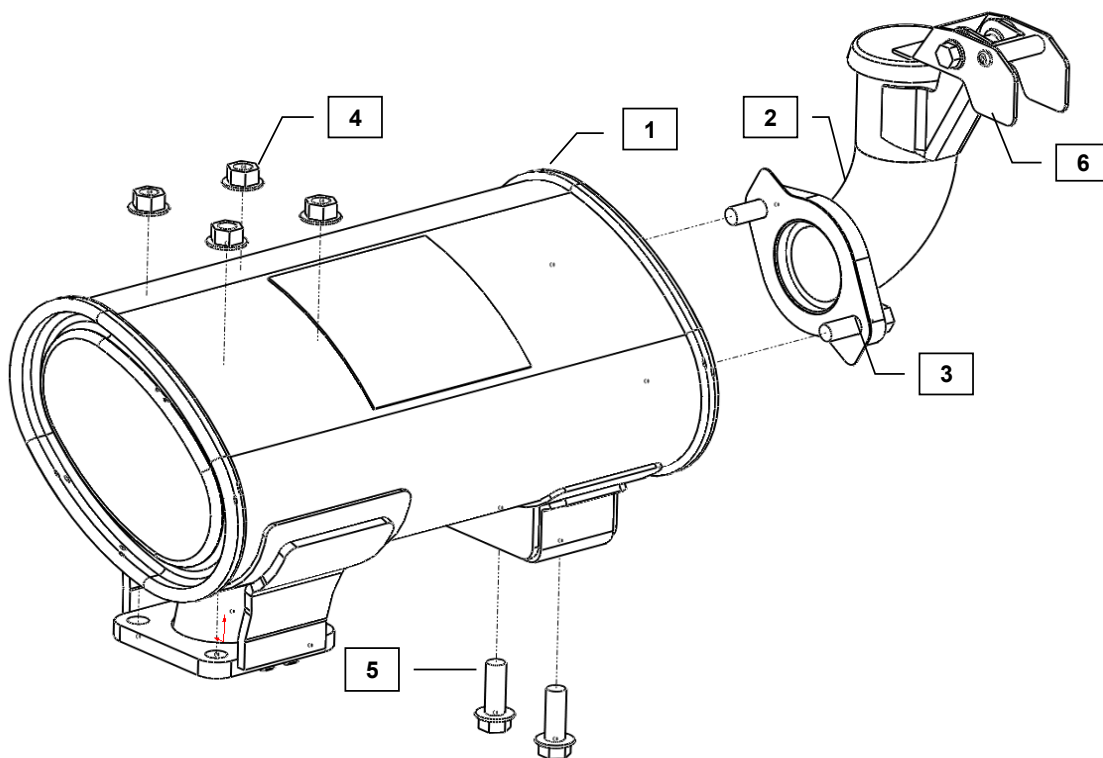

**MODELS**

3TNM68  
3TNM72

Note: Service parts are denoted by an asterisk. To replace non-service parts, the entire kit will need to be purchased.



## Installation Instructions

### WARNING: DO NOT INSTALL KIT WHILE THE ENGINE IS STILL HOT!

Hand tighten all bolts and nuts until assembly is completed, then torque according to specifications in Table 1.

1. Place the exhaust gasket included with the engine onto the exhaust manifold stud bolts.
2. Place the Silencer (1) onto the exhaust manifold bolts with the M8 Flange Nuts provided (6).
3. Insert the M8x1.25 - 25 Bolts (5) through the exhaust manifold support flange and into the threaded holes in the exhaust silencer.
4. Torque all exhaust silencer bolts to the specification provided in the chart below.
5. Fasten the Tail Pipe (2) to the exhaust Silencer (1) with the Gasket (3) provided. Torque the M8x1.25 - 25 Bolts (5) according to the torque table.
6. Fasten the Rain Cap (6) to the Tail Pipe with the hardware included. The Rain Cap (6) may be orientated as desired.

**Table 1: Proper torque specifications for bolts and nuts.**

Diameter x Pitch	Kgf-m	Foot-lbf	N-m
M8 x 1.25	1.5 ~ 2.9	10.6 ~ 20.9	14.4 ~ 28.3