



Supplement to Yanmar Kit Installation Instructions

SAFETY

This product is designed and intended only for use with a YANMAR engine. All safety and warning information contained in the Yanmar Operation Manual and Service Manual is adopted and incorporated to apply to the components, accessories, and parts that are utilized with Yanmar engines. Follow all instructions and precautions before installing this product, before operating, during operation, and during periodic maintenance procedures for your safety, the safety of others, and to protect the performance of your engine.



Item	Part No.	Description	Quantity	Remarks
1	129508-13521*	Muffler	1	
2	129403-13540*	Support bracket, muffler	1	
3	26106-080122*	Bolt, M8 x 1.25 - 12 (Flanged hex head)	2	
4	26106-080202*	Bolt, M8 x 1.25 - 20 (Flanged hex head)	2	
5	26306-080002*	Nut, M8 x 1.25 (Flanged hex head)	5	

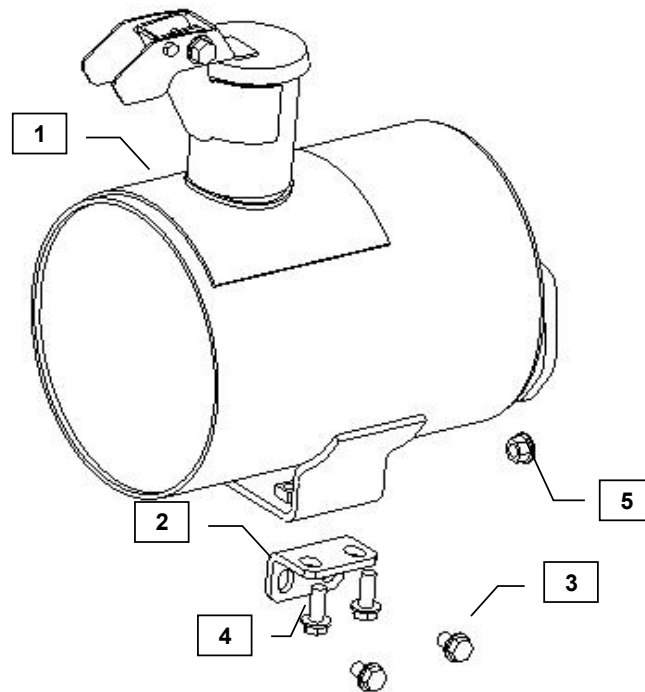

MODELS
4TNV84T

Notes: Parts code is not assigned to non-serviceable component parts.



Installation Instructions

WARNING: DO NOT INSTALL THE KIT WHILE THE ENGINE IS STILL HOT

Hand tighten all bolts and nuts until the assembly is completed, then torque to the specifications in Table 1 below.

1. Place the exhaust gasket included with the engine onto the turbocharger outlet flange.
2. Mount Muffler (1) to the turbocharger outlet using the M8x1.25 Flange Nuts (5).
3. Mount the longer side of the Muffler Bracket (2) to the exhaust manifold with M8x1.25 - 12 bolts (3)
4. Mount the Muffler (1) to the Muffler Bracket (2) using the M8x1.25 - 20 Bolts.
5. Adjust the Muffler (1) to keep the load on the Muffler Bracket (2) and NOT on the turbocharger.

Table 1: Proper torque specifications for bolts and nuts.

Diameter x Pitch	Kgf-m	Foot-lbf	N-m
M8 x 1.25	1.5 ~ 2.9	10.6 ~ 20.9	14.4 ~ 28.3