



Supplement to Yanmar Kit Installation Instructions

SAFETY

This product is designed and intended only for use with a YANMAR engine. All safety and warning information contained in the Yanmar Operation Manual and Service Manual is adopted and incorporated to apply to the components, accessories, and parts that are utilized with Yanmar engines. Follow all instructions and precautions before installing this product, before operating, during operation, and during periodic maintenance procedures for your safety, the safety of others, and to protect the performance of your engine.



Item	Part No.	Description	Quantity	Remarks
1	119128-08111	Mounting Foot	2	
2	26106-100202*	Bolt, M10x1.5-20 (Flanged Hex Head)	4	

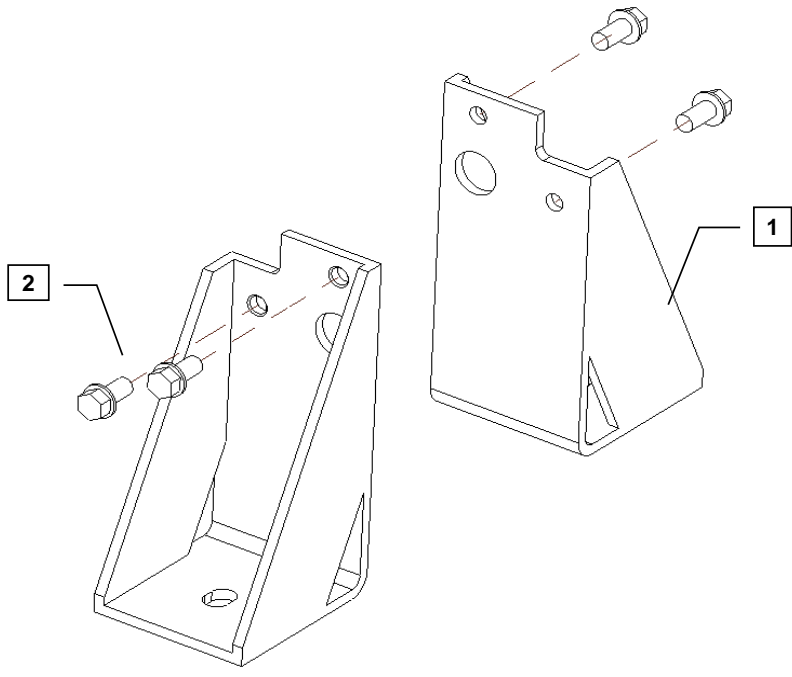

MODELS
3TNM68
3TNM72

Note: Service parts are denoted by an asterisk. To replace non-service parts, the entire kit will need to be purchased.



Installation Instructions

The MINIMAX engine foot kit has been designed so each leg can be mounted on any engine-mounting pad. You DO NOT need a special kit for the front or the rear engine mounting pads.

Hand tighten all bolts and nuts until assembly is completed, then torque according to specifications in Table 1. The numbers in () below reference the item numbers on page 1.

1. Install Engine Mounting Feet (1) to engine mounting pads using the M10 x 1.5 - 20 Bolts (2) provided in kit. Only two bolts are required for each foot.

Table 1: Comply with torque standards in the table to avoid unexpected damage during installation or in the future.

Diameter x Pitch	Kgf-m	Foot-lbf	N-m
M10 x 1.50	4.5 ~ 5.5	32.5 ~ 39.8	44.0 ~ 54.0